

Thermoplastic

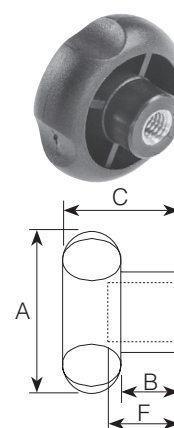

Thermoplastic

MALE							FEMALE
Plated Steel Insert Part No.	A	B	C	Thread	M Thread Length	F Thread Depth	Brass Insert Part No.
HT20M4X10S	20	5	13	M4	10		
HT20M4X15S	20	5	13	M4	15		
HT20M5X10S	20	5	13	M5	10	7	HT20M5BS
HT20M5X15S	20	5	13	M5	15		
HT20M6X15S	20	5	13	M6	15		
HT20M6X25S	20	5	13	M6	25		
HT20M6X40S	20	5	13	M6	40		
HT25M6X15S	25	6	15	M6	15	7	HT25M6BS
HT25M6X25S	25	6	15	M6	25		
HT25M6X40S	25	6	15	M6	40		
HT25M8X15S	25	6	15	M8	15		
HT25M8X25S	25	6	15	M8	25		
HT25M8X40S	25	6	15	M8	40		
HT30M6X15S	30	8	22	M6	15		
HT30M6X25S	30	8	22	M6	25		
HT30M6X40S	30	8	22	M6	40		
HT30M8X15S	30	8	22	M8	15	14	HT30M8BS
HT30M8X25S	30	8	22	M8	25		
HT30M8X40S	30	8	22	M8	40		
HT40M6X20S	40	9	28	M6	20		
HT40M6X30S	40	9	28	M6	30		
HT40M6X40S	40	9	28	M6	40		
HT40M8X20S	40	9	28	M8	20	14	HT40M8BS
HT40M8X30S	40	9	28	M8	30		
HT40M8X40S	40	9	28	M8	40		
HT40M10X20S	40	9	28	M10	20		
HT40M10X30S	40	9	28	M10	30		
HT40M10X40S	40	9	28	M10	40		
HT50M10X30S	50	10	32	M10	30	13	HT50M10BS
HT50M10X40S	50	10	32	M10	40		
HT50M10X50S	50	10	32	M10	50		
HT50M12X20S	50	10	32	M12	20		
HT50M12X40S	50	10	32	M12	40		
HT60M12X30S	60	14	38	M12	30	18	HT60M12BS
HT60M12X50S	60	14	38	M12	50		